

MANUAL FADERS

SVA(LSVA)-6100
SVA(LSVA)-1100

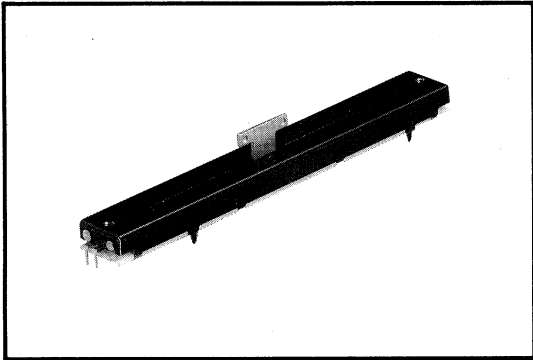

形名指定方法 Numbering System

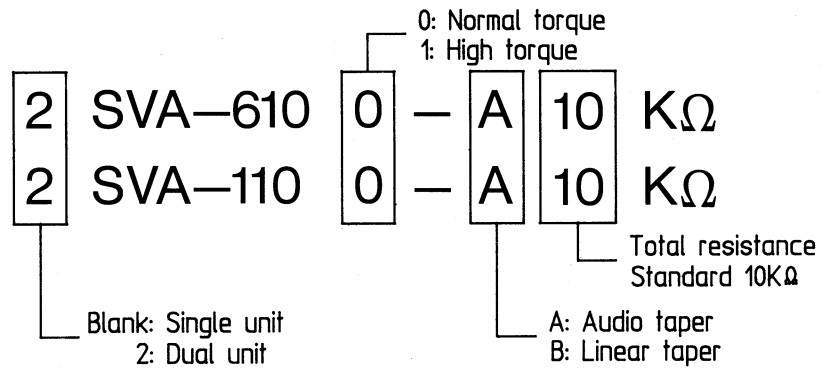

SVH(LSVH)-6100
SVH(LSVH)-1100

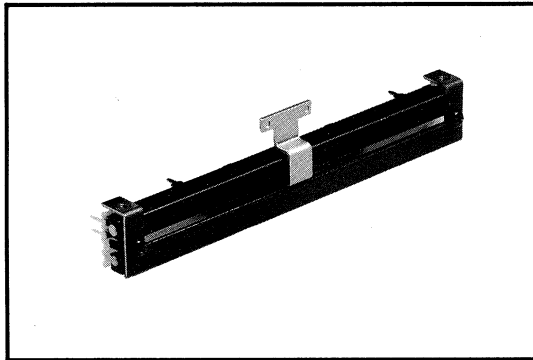

形名指定方法 Numbering System

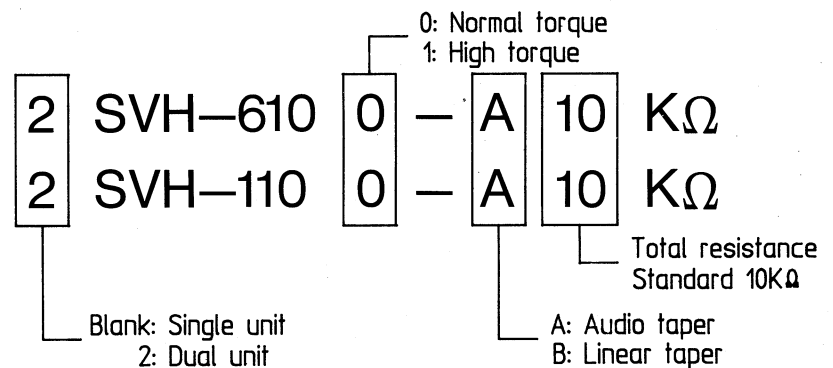

仕様 Specifications

形名	MODEL	SVA SVH	2SVA 2SVH
回路数 (不平衡回路)	number of channels (unbalanced)	1	2
抵抗変化特性	output law	Audio taper or Linear taper	
全抵抗値(許容差±20%)	total resistance±20%	10KΩ (standard)	
減衰量偏差	attenuation accuracy	0~20dB ±2.0dB	
連動偏差	maching accuracy	0~20dB ±2.0dB	
挿入損失	insertion loss maximum	0.5dB	
最大減衰量 (15KHz)	cut off at 15KHz minimum	95dB	
定格	voltage rating	not to exceed 20V DC.	
絶縁抵抗	insulation resistance	50MΩ or more at DC 250V	

Option

knob: CP-2
dustcover

形名	MODEL	LSVA LSVH	2LSVA 2LSVH
回路数 (不平衡回路)	number of channels (unbalanced)	1	2
減衰量偏差	attenuation accuracy	0~20dB ±3.0dB	
連動偏差	maching accuracy	0~20dB ±3.0dB	
絶縁抵抗	insulation resistance	50MΩ or more at DC 100V	

Option

knob: CP-2
dustcover

外形图 Dimensions

SVA-6100

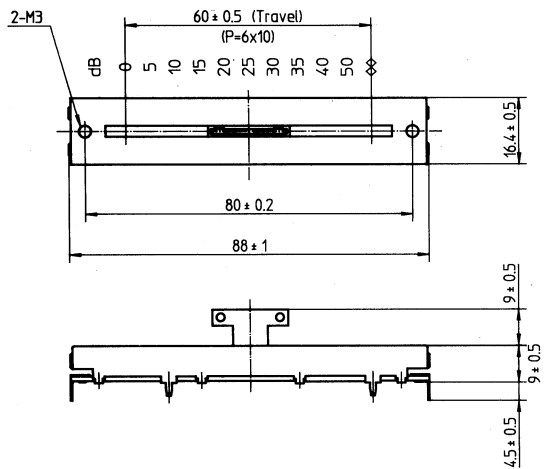

SVA-1100

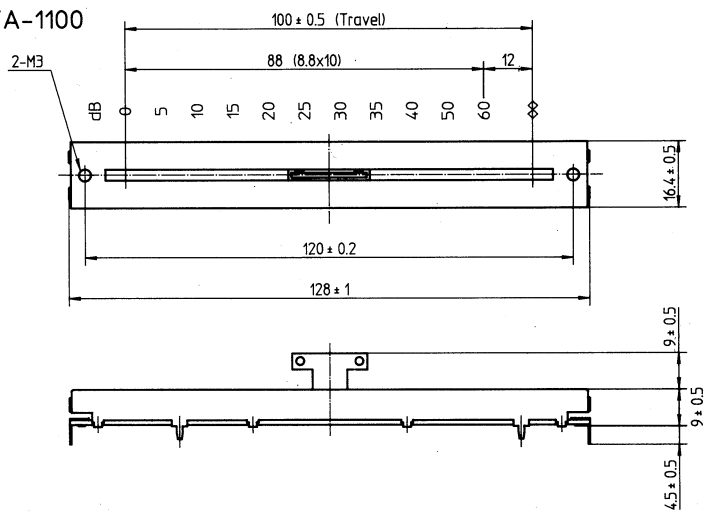

SVH-6100

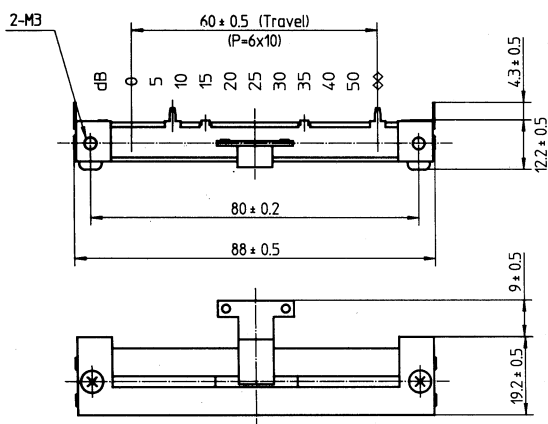

SVH-1100

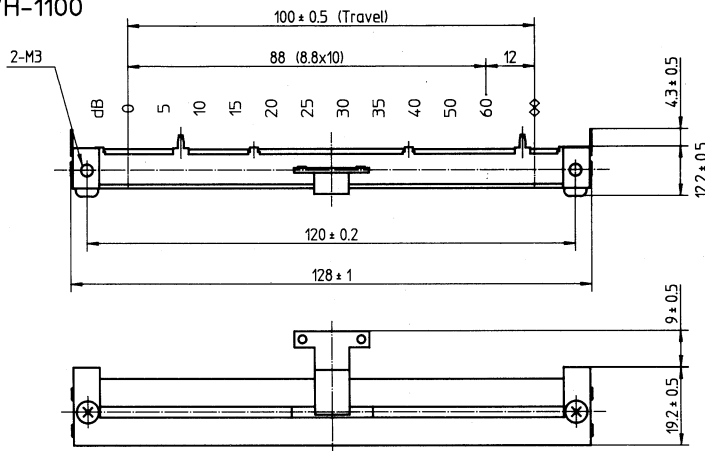

Mounting hole detail
Viewed from mounting side

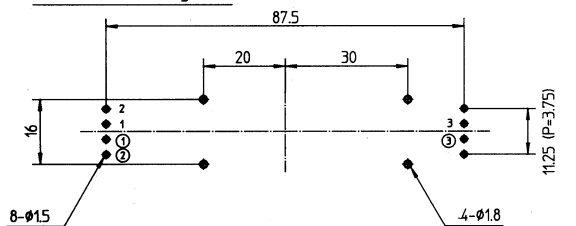

Mounting hole detail
Viewed from mounting side

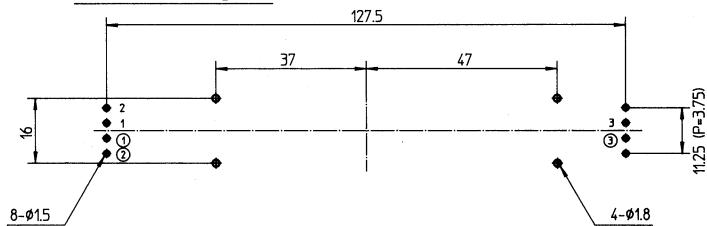

回路图 Circuit

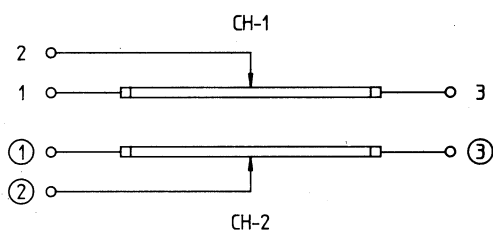

端子形状 Terminal style

